

L6W

- Aluminum-Alloy IP65 single point load cell
- Colourless anodized
- Suitable for single or double load cell structured platform scales
- Max platform size:
for 50kg-200kg: 600mmx600mm
for 250kg-635kg: 600x800mm

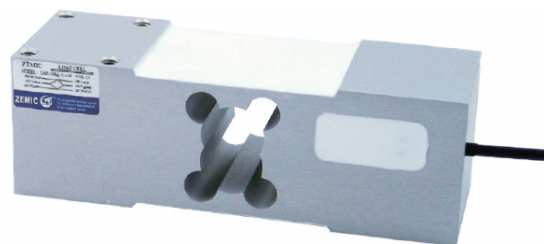

Features

- Capacities: 50kg~635kg
- High accuracy
- NTEP Cert. No.: 12-006
- OIML Cert. No.: R/60/2000-CNI-06.03
- PTB Approval No.: D09-06.12



OIML test certificate no. D09-06.12
C of C no R60/2000-CN1-06.03

NTEP Certificate no. 12-006

Specifications

Capacity	kg	50/100/150/200/250/300/500/635
Accuracy		C3
Maximum Number of Verification Intervals	Nmax	3000
Minimum Number of Verification Intervals	Vmin	E _{max} /7000
Output Sensitivity	(mV/V)	2.0±0.2
Input Resistance	(Ω)	406±6
Output Resistance	(Ω)	350±3
Insulation Resistance	(MΩ)	≥5000 (50VDC)
Zero Balance	(%FS)	2
Temperature, Compensated	(°C)	-10~+40
Temperature, Operating	(°C)	-35~+70
Excitation, Recommended	(V)	5~12 (DC)
Excitation, Max	(V)	18 (DC)
Safe Overload	(%FS)	150
Ultimate Overload	(%FS)	300

Dimensions in mm (in)

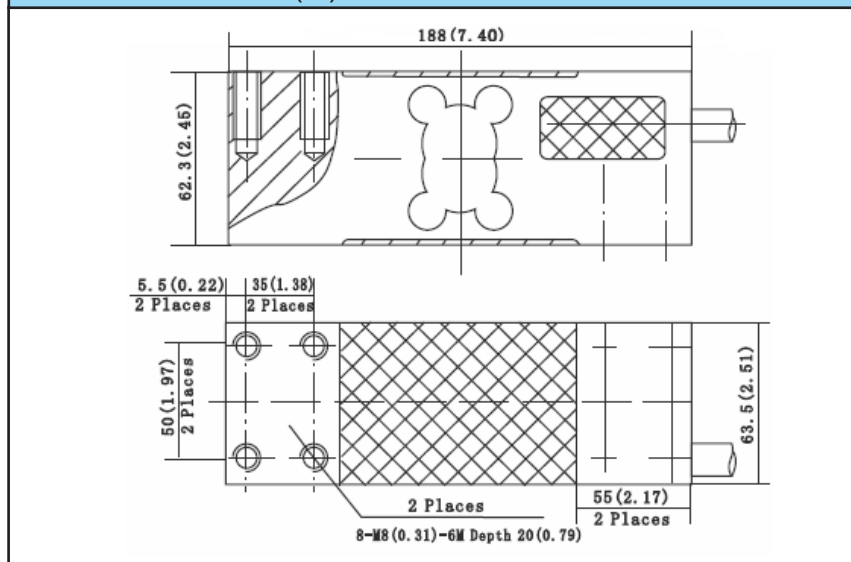

Wiring

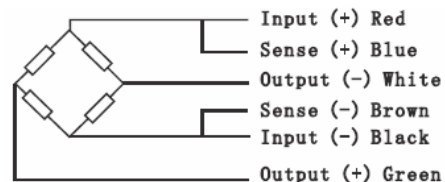

- Shielded, 6 conductor cable
- Cable diameter: 0.19in
- Standard cable length: 3m
- Shield connected to element
- Cable jacket in PU